

Sandhills Mitigation Bank.

Lexington County, **South Carolina**.

Design (left) and as built in 2006 (right).

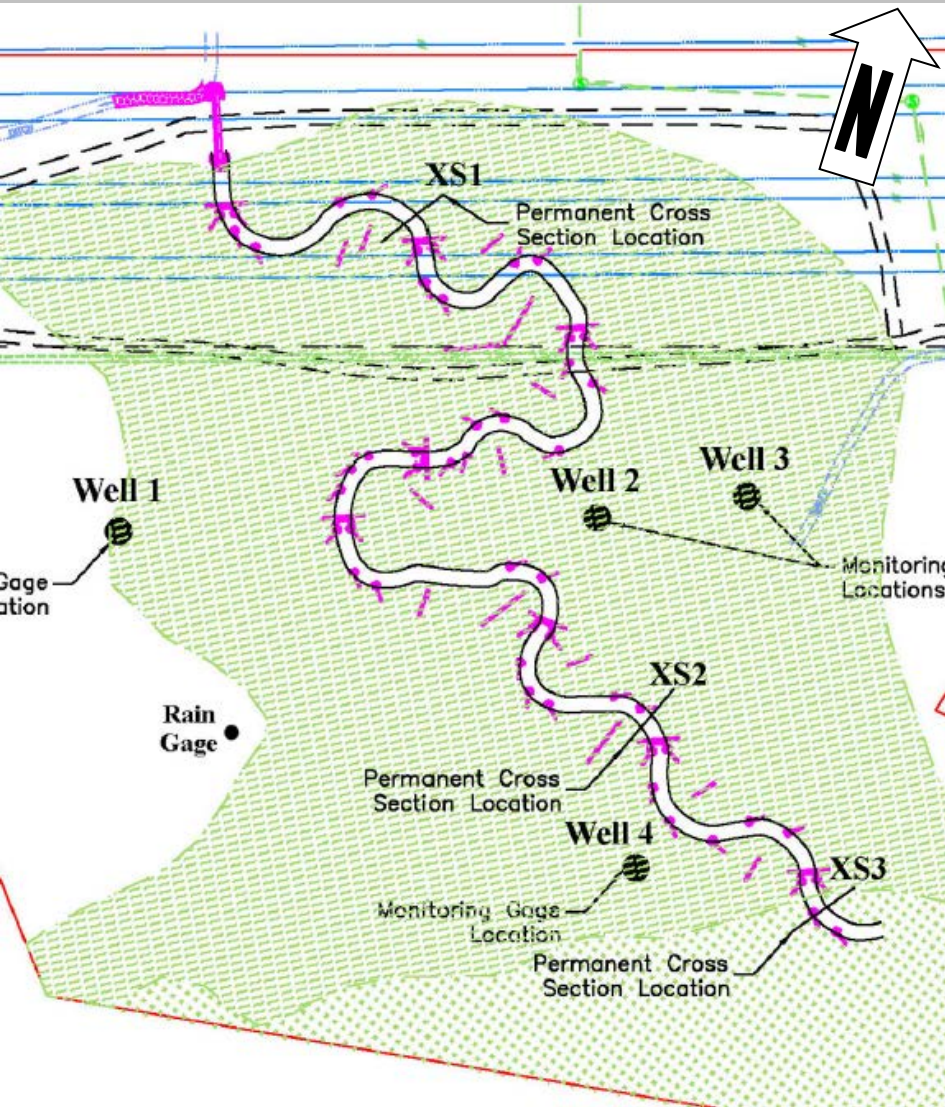



Sandhills Mitigation Bank
Lexington County,
South Carolina

Aerial view of restored stream.
Channel was constructed in 2006.
Imagery is from 2012 (Bing).
*Note this is a different orientation
than previous slide.*

